

**TITLE**

HYDRAULIC POWER - CV02-193 CHECK VALVE INSPECTION

**EFFECTIVITY****MODEL**

525 (M2)

**SERIAL NUMBERS**

-1070 thru -1073, -1075, -1076, -1078

The equivalent of this service document has been incorporated on production airplanes -1074, -1077, -1079 and On.

**REASON**

The CV02-193 Check Valve may have been installed without an internal spring guide. If the CV02-193 Check Valve does not have the internal spring guide, the CV02-193 Check Valve may not operate correctly.

**DESCRIPTION**

This service document provides parts and instructions to do an inspection of the CV02-193 Check Valve.

**COMPLIANCE**

RECOMMENDED. This service document should be accomplished at a scheduled maintenance period or inspection.

A service document published by Textron Aviation may be recorded as *completed* in an aircraft log only when the following requirements are satisfied:

- 1) The mechanic must complete all of the instructions in the service document, including the intent therein.
- 2) The mechanic must correctly use and install all applicable parts supplied with the service document kit. Only with written authorization from Textron Aviation can substitute parts or rebuilt parts be used to replace new parts.
- 3) The mechanic or airplane owner must use the technical data in the service document only as approved and published.
- 4) The mechanic or airplane owner must apply the information in the service document only to aircraft serial numbers identified in the *Effectivity* section of the document.
- 5) The mechanic or airplane owner must use maintenance practices that are identified as acceptable standard practices in the aviation industry and governmental regulations.

No individual or corporate organization other than Textron Aviation is authorized to make or apply any changes to a Textron Aviation-issued service document or flight manual supplement without prior written consent from Textron Aviation.

Textron Aviation is not responsible for the quality of maintenance performed to comply with this document, unless the maintenance is accomplished at a Textron Aviation-owned Service Center.

**CONSUMABLE MATERIAL**

No specialized consumable materials are required to complete this service document.

**TOOLING**

No specialized tooling is required to complete this service document.

July 20, 2021

SL525-29-04  
Page 1 of 4

Textron Aviation Customer Service, P.O. Box 7706, Wichita, KS 67277, U.S.A. 1-316-517-5800

This document contains technical data and is subject to U.S. export regulations. This information has been exported from the United States in accordance with export administration regulations. Diversion contrary to U.S. law is prohibited. ECCN: 9E991

## REFERENCES

Cessna Model 525 (0685 and 0800 & On) Maintenance Manual

## ACCOMPLISHMENT INSTRUCTIONS

1. Prepare the airplane for maintenance.
  - A. Make sure that the airplane is electrically grounded.
  - B. Make sure that all switches are in the OFF/NORM position.
  - C. Disconnect electrical power from the airplane.
    - (1) Disconnect external electrical power.
    - (2) Disconnect the airplane batteries.
  - D. Attach maintenance warning tags to the batteries and external power receptacle that have "**DO NOT CONNECT ELECTRICAL POWER - MAINTENANCE IN PROGRESS**" written on them.
2. Remove aft baggage compartment access panel 321A. (Refer to the Model 525 (0685 and 0800 & On) Maintenance Manual, Chapter 6, Access Plates and Panels Identification - Description and Operation.)
3. (Refer to Figure 1, Detail A and Detail B.) Do a visual inspection of the CV02-193 Check Valve.

**NOTE:** The CV02-193 Check Valve will be installed between the upper and the lower reservoir pressure tubes on the right side of the tailcone.

- A. If the manufacturing date is 09/20 and the cure date is 1Q15, remove and replace the CV02-193 Check Valve. Go to Step 4.

**NOTE:** The manufacturing date is shown next to the part number on the CV02-193 Check Valve.

**NOTE:** The cure date is shown on the bottom row on the CV02-193 Check Valve.

- B. If the manufacturing date is not 09/20 and the cure date is not 1Q15, no further action is required. Go to Step 6.

4. (Refer to Figure 1, Detail A and Detail B.) Remove the current CV02-193 Check Valve. (Refer to the Model 525 (0685 and 0800 & On) Maintenance Manual, Chapter 29, Main Hydraulic System - Maintenance Practices.)
5. (Refer to Figure 1, Detail A and Detail B.) Install a new CV02-193 Check Valve. (Refer to the Model 525 (0685 and 0800 & On) Maintenance Manual, Chapter 29, Main Hydraulic System - Maintenance Practices.)
6. Install aft baggage compartment access panel 321A. (Refer to the Model 525 (0685 and 0800 & On) Maintenance Manual, Chapter 6, Access Plates and Panels Identification - Description and Operation.)
7. Remove the maintenance warning tags and connect the airplane batteries.
8. Make an entry in the airplane logbook that states compliance and method of compliance with this service document.

**NOTE:** Textron Aviation recommends that compliance with all service documents is reported to a maintenance tracking system provider.

  - Complete a record of compliance. (Maintenance Transaction Report, Log Book Entry, or other record of compliance.)
  - Put a copy of the completed record of compliance in the airplane logbook.
  - Send a copy of the completed record of compliance to the maintenance tracking system provider used.

A111606

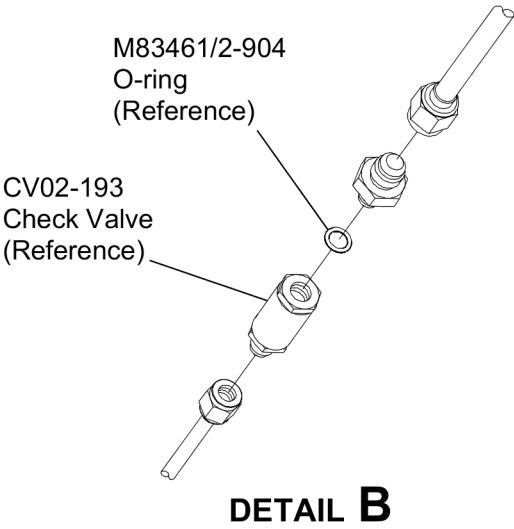
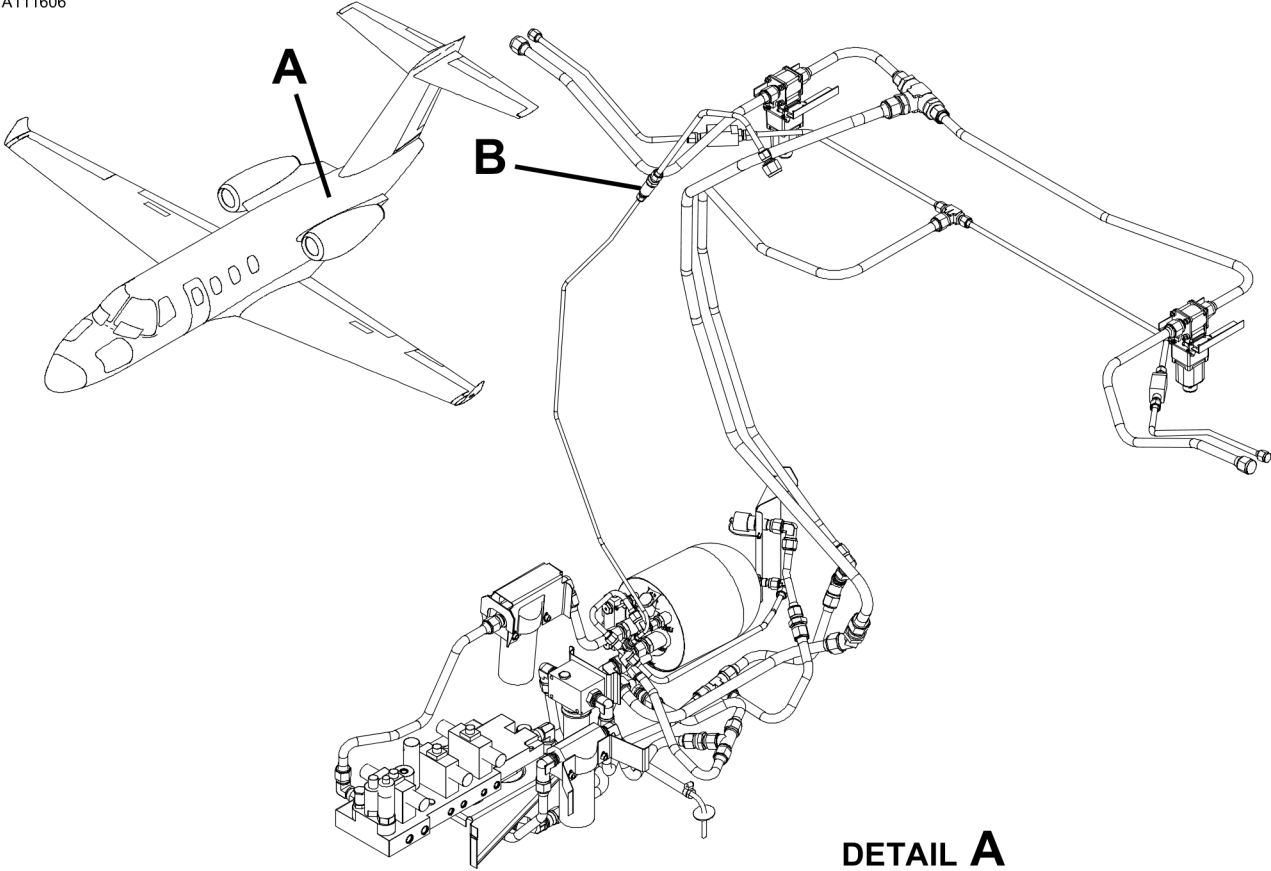

Figure 1. CV02-193 CHECK VALVE INSPECTION (Sheet 1)

6310T1168  
A6317T1138  
B6317T1197

**MATERIAL INFORMATION**

It may be necessary to order the parts below to install this modification.

<b>NEW P/N</b>	<b>QUAN- TITY</b>	<b>KEY WORD</b>	<b>OLD P/N</b>	<b>INSTRUCTIONS/ DISPOSITION</b>
CV02-193	If Required	Check Valve		
M83461/2-904	If Required	O-ring		

\*Please contact your Regional Textron Aviation Parts Distribution Customer Support Team for current cost and availability of parts listed in this service document. For more information, please visit the TAPD Support & Aftermarket Account Management website at <https://ww2.txtav.com/Parts/Promos/TAPD>.

**TITLE**

HYDRAULIC POWER - CV02-193 CHECK VALVE INSPECTION

**TO:**

Citation M2 Aircraft Owner

**REASON**

The CV02-193 Check Valve may have been installed without an internal spring guide. If the CV02-193 Check Valve does not have the internal spring guide, the CV02-193 Check Valve may not operate correctly.

**COMPLIANCE**

RECOMMENDED. This service document should be accomplished at a scheduled maintenance period or inspection.

**LABOR HOURS**

WORK PHASE	LABOR-HOURS
Modification	1.0
Test and Inspection	1.0

**MATERIAL AVAILABILITY**

PART NUMBER	AVAILABILITY	COST
CV02-193	*	*
M83461/2-904	*	*

\*Please contact your Regional Textron Aviation Parts Distribution Customer Support Team for current cost and availability of parts listed in this service document. For more information, please visit the TAPD Support & Aftermarket Account Management website at <https://ww2.txtav.com/Parts/Promos/TAPD>.

**WARRANTY**

This service document is *recommended*. Eligible airplanes may qualify for parts and labor coverage to the extent noted in the *Labor Hours* and *Material Availability* sections of this document.

July 20, 2021

SL525-29-04  
Page 1 of 2

Textron Aviation Customer Service, P.O. Box 7706, Wichita, KS 67277, U.S.A. 1-316-517-5800

This document contains technical data and is subject to U.S. export regulations. This information has been exported from the United States in accordance with export administration regulations. Diversion contrary to U.S. law is prohibited. ECCN: 9E991

**Eligibility:** Airplanes identified within the serial number effectivity of this service document must have active Airframe warranty coverage on the original issue date of this document and the coverage must be active on the day the work is accomplished.

**Parts Coverage:** Textron Aviation-owned and Textron Aviation-authorized Service Facilities, operators, or other maintenance facilities may submit a claim for the parts required to accomplish this service document as defined in the *Material Availability* section of this document.

**Labor Coverage:** Textron Aviation-owned and Textron Aviation-authorized Service Facilities rated to perform maintenance on the specific model of Cessna Aircraft may submit a claim for the labor necessary to accomplish this service document as defined in the *Labor Hours* section of this document.

**Credit Application:** After this service document has been accomplished, a claim must be submitted to Textron Aviation within 30 days of the service document completion. Claims for compliance of this service document are to be filed as a W4 type claim.

Please submit your claim form online at [ww2.txtav.com/Parts](http://ww2.txtav.com/Parts) or email the completed Textron Aviation Claim Form to [warranty@txtav.com](mailto:warranty@txtav.com). If submitted on-line a Return Authorization will be provided. If a paper claim is submitted your claim will be entered into the system and a Return Authorization will be sent to you.

The Return Authorization must accompany any required return parts (see *Material Availability*), to the point of purchase.

Parts to be returned to Textron Aviation Parts Distribution should be forwarded to:

Textron Aviation Parts Distribution  
Warranty Administration  
285 South Greenwich Road  
Bldg B89, Docks 1-4  
Wichita, KS 67206  
USA

**Expiration:** July 20, 2023 (after this date the owner/operator assumes the responsibility for compliance costs)

Textron Aviation reserves the right to void continued airplane warranty coverage for the parts affected by this service document until the service document is accomplished.

**NOTE:** As a convenience, service documents are now available online to all our customers through a simple, free-of-charge registration process. If you would like to sign up, please visit the Customer Access link at [www.txtavsupport.com](http://www.txtavsupport.com) to register.