

**TITLE**

FUSELAGE - RADOME LATCH IMPROVEMENT

**EFFECTIVITY****MODEL**

525 (M2)

**SERIAL NUMBERS**

-0685, -0800 thru -1077

The equivalent of this service bulletin has been incorporated on production airplanes -1078 and On.

**REASON**

The current latch may be difficult to access with Garmin avionics boxes installed.

**DESCRIPTION**

This service bulletin provides parts and instructions to replace the current latch with a shorter latch.

**COMPLIANCE**

OPTIONAL. This service document should be accomplished at a scheduled maintenance period or inspection.

A service document published by Textron Aviation may be recorded as *completed* in an aircraft log only when the following requirements are satisfied:

- 1) The mechanic must complete all of the instructions in the service document, including the intent therein.
- 2) The mechanic must correctly use and install all applicable parts supplied with the service document kit. Only with written authorization from Textron Aviation can substitute parts or rebuilt parts be used to replace new parts.
- 3) The mechanic or airplane owner must use the technical data in the service document only as approved and published.
- 4) The mechanic or airplane owner must apply the information in the service document only to aircraft serial numbers identified in the *Effectivity* section of the document.
- 5) The mechanic or airplane owner must use maintenance practices that are identified as acceptable standard practices in the aviation industry and governmental regulations.

No individual or corporate organization other than Textron Aviation is authorized to make or apply any changes to a Textron Aviation-issued service document or flight manual supplement without prior written consent from Textron Aviation.

Textron Aviation is not responsible for the quality of maintenance performed to comply with this document, unless the maintenance is accomplished at a Textron Aviation-owned Service Center.

**APPROVAL**

Textron Aviation received FAA approval for the technical data in this publication that changes the airplane type design.

**FLIGHT CREW OPERATIONS**

No Changes

June 17, 2021

SB525-53-21  
Page 1 of 5

Textron Aviation Customer Service, P.O. Box 7706, Wichita, KS 67277, U.S.A. 1-316-517-5800

This document contains technical data and is subject to U.S. export regulations. This information has been exported from the United States in accordance with export administration regulations. Diversion contrary to U.S. law is prohibited. ECCN: 9E991

**CONSUMABLE MATERIAL**

No specialized consumable materials are required to complete this service document.

**TOOLING**

No specialized tooling is required to complete this service document.

**WEIGHT AND BALANCE INFORMATION**

Negligible

**REFERENCES**

Cessna Model 525 (0685 and 0800 & On) Maintenance Manual

**PUBLICATIONS AFFECTED**

Cessna Model 525 (0685 and 0800 & On) Illustrated Parts Catalog

**ACCOMPLISHMENT INSTRUCTIONS**

1. Prepare the airplane for maintenance.
  - A. Make sure that the airplane is electrically grounded.
  - B. Make sure that all switches are in the OFF/NORM position.
  - C. Disconnect electrical power from the airplane.
    - (1) Disconnect the airplane batteries.
    - (2) Disconnect external electrical power.
  - D. Attach maintenance warning tags to the batteries and external power receptacle that have **"DO NOT CONNECT ELECTRICAL POWER - MAINTENANCE IN PROGRESS"** written on them.
2. Open the left and right nose baggage compartment doors. Remove access panels 211BZ and 212HZ. (Refer to the 525 (0685 and 0800 & On) Maintenance Manual, Chapter 6, Access Plates and Panels Identification - Description and Operation).
3. Remove the Nose Radome. (Refer to the 525 (0685 and 0800 & On) Maintenance Manual, Chapter 53, Nose Radome - Maintenance Practices).
4. Remove and retain the four AN3-6A bolts that attach the S2893-15 Rotary Latch Assembly to the bracket assembly.
5. Remove and discard the S2893-15 Rotary Latch Assembly.
6. (Refer to Figure 1). Install the new S2893-8 Rotary Latch Assembly using the retained AN3-6A Bolts.  
**NOTE:** Install S2893-8 with the latch opening facing forward.
7. Install the Nose Radome. (Refer to the 525 (0685 and 0800 & On) Maintenance Manual, Chapter 53, Nose Radome - Maintenance Practices).
8. Install access panels 211BZ and 212HZ. (Refer to the 525 (0685 and 0800 & On) Maintenance Manual, Chapter 6, Access Plates and Panels Identification - Description and Operation).
9. Close the left and right nose baggage compartment doors.
10. Remove the maintenance warning tags and connect the airplane batteries.

11. Make an entry in the airplane logbook that states compliance and method of compliance with this service document.

**NOTE:** Textron Aviation recommends that compliance with all service documents is reported to a maintenance tracking system provider.

- Complete a record of compliance. (Maintenance Transaction Report, Log Book Entry, or other record of compliance.)
- Put a copy of the completed record of compliance in the airplane logbook.
- Send a copy of the completed record of compliance to the maintenance tracking system provider used.

A110893

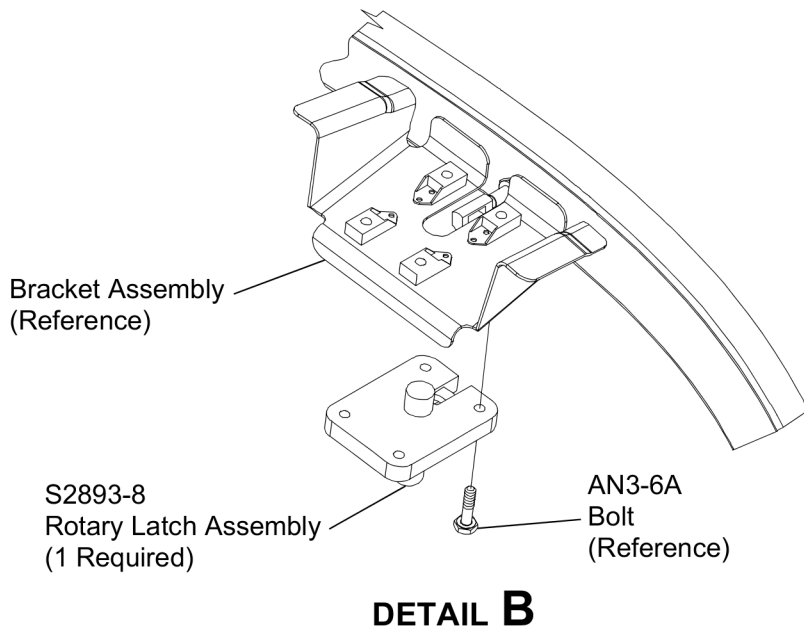
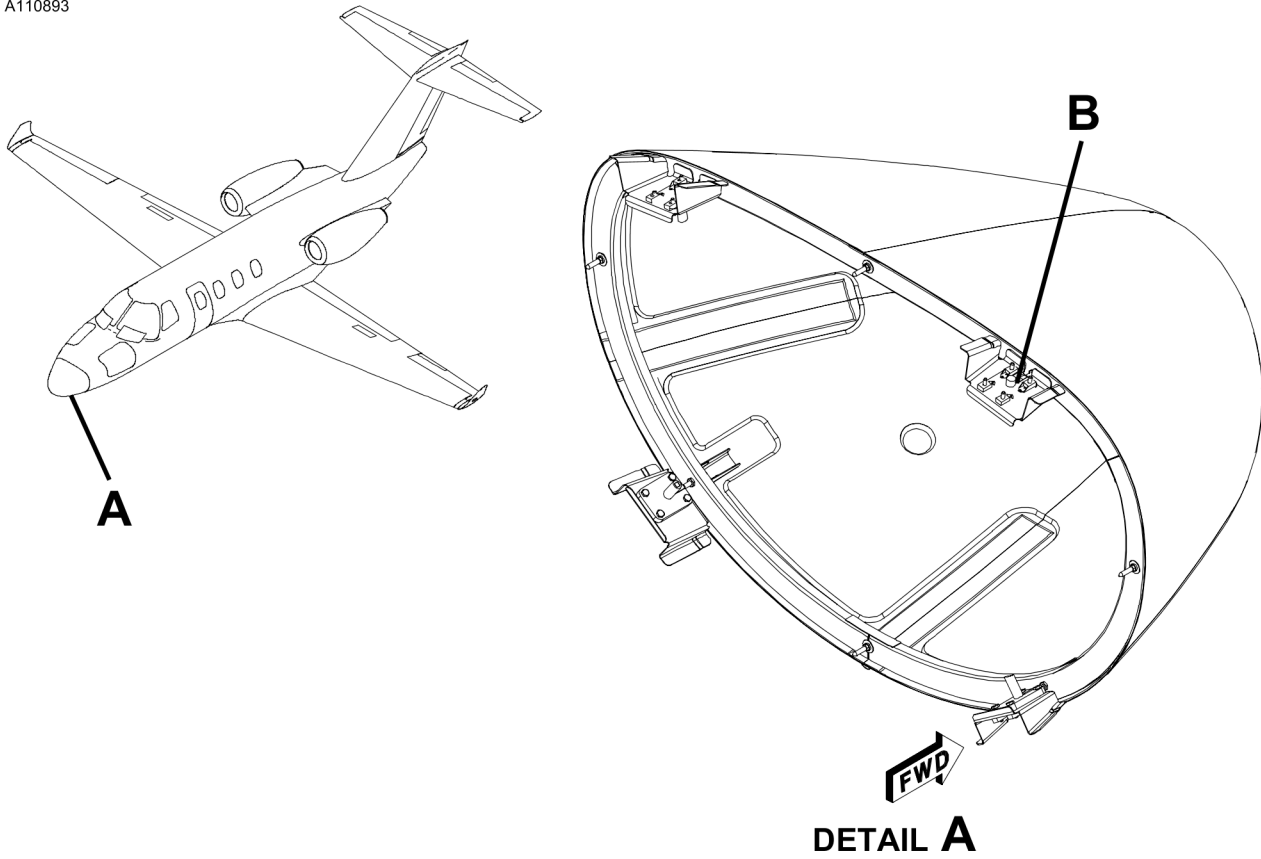

Figure 1. Radome Latch Installation (Sheet 1)

6310T1168  
A-B6390148-1

**MATERIAL INFORMATION**

It will be necessary the part below to install this modification.

<b>NEW P/N</b>	<b>QUANTITY</b>	<b>KEY WORD</b>	<b>OLD P/N</b>	<b>INSTRUCTIONS/ DISPOSITION</b>
S2893-8	1	Rotary Latch Assembly	S2893-15	Discard

\* Please contact Textron Aviation Parts Distribution for current cost and availability of parts listed in this service document. Phone at 1-800-835-4000 (Domestic) or 1-316-517-5603 (International). Send email to: [parts@txtav.com](mailto:parts@txtav.com).

Based on availability and lead times, parts may require advanced scheduling.



**TITLE**

FUSELAGE - RADOME LATCH IMPROVEMENT

**TO:**

Cessna Model 525 (M2) Aircraft Owner

**REASON**

The current latch may be difficult to access with Garmin avionics boxes installed.

**COMPLIANCE**

OPTIONAL. This service bulletin can be accomplished at the discretion of the owner.

**LABOR HOURS**

WORK PHASE	LABOR-HOURS
Modification	As Required

**MATERIAL AVAILABILITY**

Order the part below to complete this service document.

PART NUMBER	AVAILABILITY	COST
S2893-8	*	*

\* Please contact Textron Aviation Parts Distribution for current cost and availability of parts listed in this service document. Phone at 1-800-835-4000 (Domestic) or 1-316-517-5603 (International). Send email to: [parts@txtav.com](mailto:parts@txtav.com).

Based on availability and lead times, parts may require advanced scheduling.

**WARRANTY**

None.

**NOTE:** As a convenience, service documents are now available online to all our customers through a simple, free-of-charge registration process. If you would like to sign up, please visit the Customer Access link at [www.txtavsupport.com](http://www.txtavsupport.com) to register.

