

REVISION TRANSMITTAL

This sheet transmits Revision 1 to SB700-52-01, which:

- A. Removes -0007 from the serial effectivity.

NOTE: This revision replaces the original issue of SB700-52-01 in its entirety.

REVISION COMPLIANCE

NO EFFECT. Airplanes previously modified by this service bulletin are not affected by this revision.

LOG OF REVISIONS

Original Issue	February 10, 2020
Revision 1	October 27, 2020

TITLE

DOORS - EMERGENCY EXIT DOOR INNER HANDLE HARDWARE REPLACEMENT

EFFECTIVITY

MODEL	SERIAL NUMBERS
700 (Citation Longitude)	-0001 thru -0006, -0008 thru -0014
The equivalent of this service document has been incorporated on production airplanes -0007 and -0015 and On.	

REASON

To replace the screw and nut that attach the emergency exit door inner handle with a clevis pin and cotter pin to eliminate the possibility of the door handle hardware from becoming loose and dislodged. Failing to comply with this Service Bulletin could result in difficulty in occupant egress from the aircraft in an emergency situation.

DESCRIPTION

This service bulletin provides parts and instructions to remove the screw and nut on the emergency exit door inner handle and replace it with a clevis pin and cotter pin.

COMPLIANCE

MANDATORY. This service document must be accomplished within 90 days from the date of receipt.

A service document published by Textron Aviation may be recorded as *completed* in an aircraft log only when the following requirements are satisfied:

- 1) The mechanic must complete all of the instructions in the service document, including the intent therein.
- 2) The mechanic must correctly use and install all applicable parts supplied with the service document kit. Only with written authorization from Textron Aviation can substitute parts or rebuilt parts be used to replace new parts.
- 3) The mechanic or airplane owner must use the technical data in the service document only as approved and published.
- 4) The mechanic or airplane owner must apply the information in the service document only to aircraft serial numbers identified in the *Effectivity* section of the document.
- 5) The mechanic or airplane owner must use maintenance practices that are identified as acceptable standard practices in the aviation industry and governmental regulations.

No individual or corporate organization other than Textron Aviation is authorized to make or apply any changes to a Textron Aviation-issued service document or flight manual supplement without prior written consent from Textron Aviation.

Textron Aviation is not responsible for the quality of maintenance performed to comply with this document, unless the maintenance is accomplished at a Textron Aviation-owned Service Center.

APPROVAL

Textron Aviation received FAA approval for the technical data in this publication that changes the airplane type design.

Original Issue - February 10, 2020
 Revision 1 - October 27, 2020

SB700-52-01
 Page 1 of 4

Textron Aviation Customer Service, P.O. Box 7706, Wichita, KS 67277, U.S.A. 1-316-517-5800

This document contains technical data and is subject to U.S. export regulations. This information has been exported from the United States in accordance with export administration regulations. Diversion contrary to U.S. law is prohibited. ECCN: 9E991

FLIGHT CREW OPERATIONS

No Changes

CONSUMABLE MATERIAL

No specialized consumable materials are required to complete this service document.

TOOLING

No specialized tooling is required to complete this service document.

WEIGHT AND BALANCE INFORMATION

Negligible

REFERENCES

Citation Standard Practices Manual

PUBLICATIONS AFFECTED

Cessna Model 700 Illustrated Parts Catalog

ACCOMPLISHMENT INSTRUCTIONS

1. Remove the emergency exit door inner handle cover.
2. Replace the emergency exit door inner handle attach hardware as follows:
 - A. Loosen and remove the NAS623-2-11 Screw and S3923C2 Nut from the emergency exit door inner handle. Discard the hardware.
 - B. Install one MS20392-13P27 Clevis Pin through the emergency exit door inner handle and latch mechanism.
 - C. Install one NAS1149FN832P Washer and MS24665-132 Cotter Pin on the end of the clevis pin. (Refer to Cessna Citation Standard Practices Manual, Chapter 20, Safetying - Maintenance Practices.)
3. Install the emergency exit door inner handle cover.
4. Make an entry in the airplane logbook that states compliance and method of compliance with this service document.

NOTE: Textron Aviation recommends that compliance with all service documents is reported to a maintenance tracking system provider.

- Complete a record of compliance. (Maintenance Transaction Report, Log Book Entry, or other record of compliance.)
- Put a copy of the completed record of compliance in the airplane logbook.
- Send a copy of the completed record of compliance to the maintenance tracking system provider used.

MANDATORY

SB700-52-01

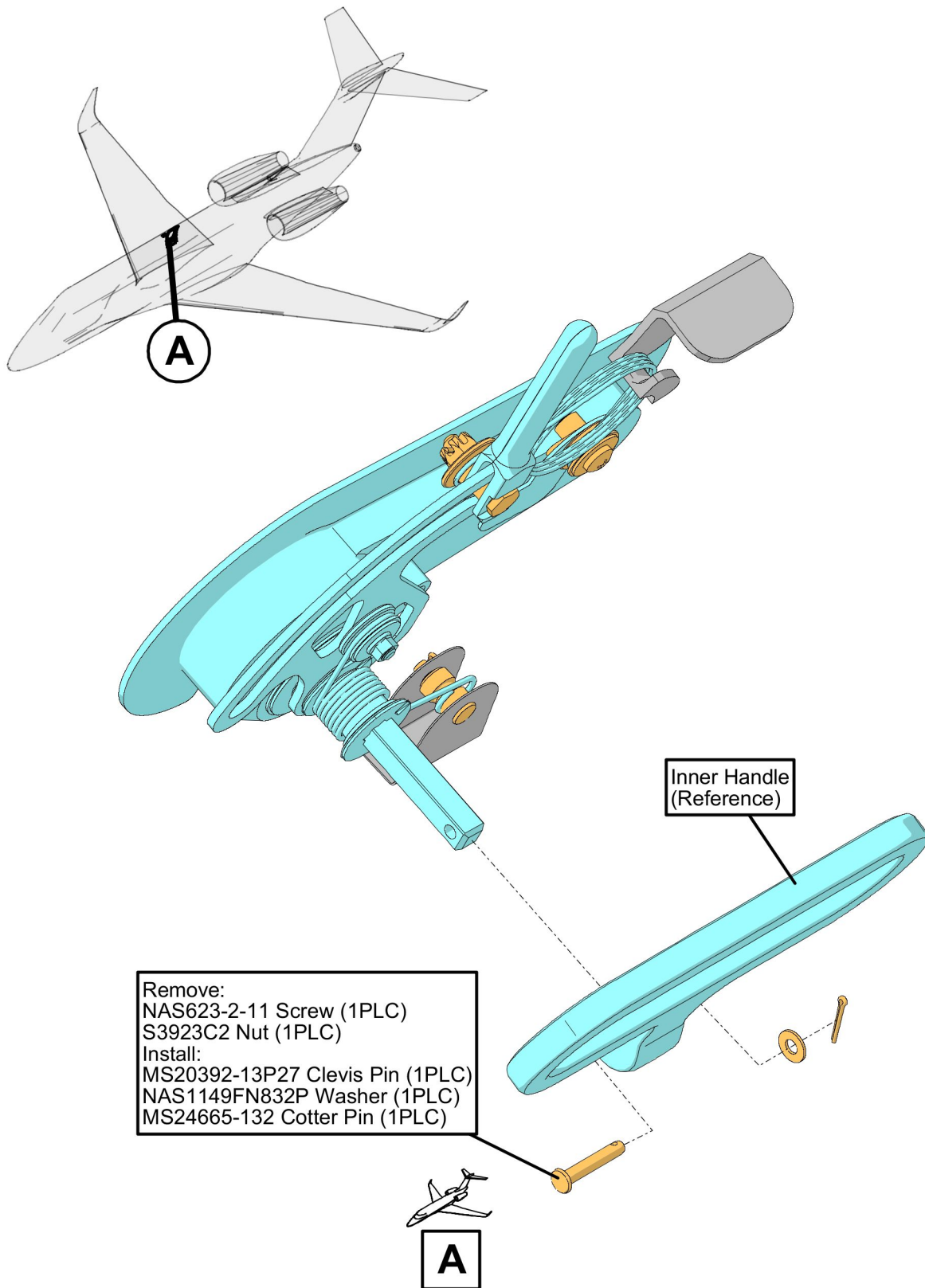

Figure 1. Emergency Exit Door Inner Handle Hardware Replacement (Sheet 1)

A7411956-2

MATERIAL INFORMATION

Order the kit/parts below to install this modification.

NEW P/N	QUANTITY	KEY WORD	OLD P/N	INSTRUCTIONS/ DISPOSITION
SB700-52-01	1	Kit , consisting of the following parts:		
MS20392-13P27	1	Clevis Pin	NAS623-2-11	Discard
MS24665-132	1	Cotter Pin	S3923C2	Discard
NAS1149FN832P	1	Washer		
SB700-52-01	1	Instructions		

* Please contact Textron Aviation Parts Distribution for current cost and availability of parts listed in this service document. Phone at 1-800-835-4000 (Domestic) or 1-316-517-5603 (International). Send email to: parts@txtav.com.

Based on availability and lead times, parts may require advanced scheduling.

TITLE

DOORS - EMERGENCY EXIT DOOR INNER HANDLE HARDWARE REPLACEMENT

TO:

Cessna Model 700 (Citation Longitude) Aircraft Owner

REASON

To replace the screw and nut that attach the emergency exit door inner handle with a clevis pin and cotter pin to eliminate the possibility of the door handle hardware from becoming loose and dislodged. Failing to comply with this Service Bulletin could result in difficulty in occupant egress from the aircraft in an emergency situation.

COMPLIANCE

MANDATORY. This service document must be accomplished within 90 days from the date of receipt.

LABOR HOURS

WORK PHASE	LABOR-HOURS
Modification	1.0

MATERIAL AVAILABILITY

Order the kit/parts below to install this modification.

PART NUMBER	AVAILABILITY	COST
SB700-52-01	*	*

* Please contact Textron Aviation Parts Distribution for current cost and availability of parts listed in this service document. Phone at 1-800-835-4000 (Domestic) or 1-316-517-5603 (International). Send email to: parts@txtav.com.

Based on availability and lead times, parts may require advanced scheduling.

WARRANTY

This service document is *mandatory*. Eligible airplanes may qualify for parts and labor coverage to the extent noted in the *Labor Hours* and *Material Availability* sections of this document.

February 10, 2020

SB700-52-01
Page 1 of 2

 Textron Aviation Customer Service, P.O. Box 7706, Wichita, KS 67277, U.S.A. 1-316-517-5800

This document contains technical data and is subject to U.S. export regulations. This information has been exported from the United States in accordance with export administration regulations. Diversion contrary to U.S. law is prohibited. ECCN: 9E991

 COPYRIGHT © 2020

Eligibility: Airplanes identified within the serial number effectivity of this service document.

Parts Coverage: Textron Aviation-owned and Textron Aviation-authorized Service Facilities, operators, or other maintenance facilities may submit a claim for the parts required to accomplish this service document as defined in the *Material Availability* section of this document.

Labor Coverage: Textron Aviation-owned and Textron Aviation-authorized Service Facilities rated to perform maintenance on the specific model of Cessna Aircraft may submit a claim for the labor necessary to accomplish this service document as defined in the *Labor Hours* section of this document.

Credit Application: After this service document has been accomplished, a claim must be submitted to Textron Aviation within 30 days of the service document completion. Claims for compliance of this service document are to be filed as a W4 type claim.

Please submit your claim form online at ww2.txtav.com/Parts or email the completed Textron Aviation Claim Form to warranty@txtav.com. If submitted on-line a Return Authorization will be provided. If a paper claim is submitted your claim will be entered into the system and a Return Authorization will be sent to you.

The Return Authorization must accompany any required return parts (see *Material Availability*), to the point of purchase.

Parts to be returned to Textron Aviation Parts Distribution should be forwarded to:

Textron Aviation Parts Distribution
Warranty Administration
285 South Greenwich Road
Bldg B89, Docks 1-4
Wichita, KS 67206
USA

Expiration: February 28, 2021

Textron Aviation reserves the right to void continued airplane warranty coverage for the parts affected by this service document until the service document is accomplished.

NOTE: As a convenience, service documents are now available online to all our customers through a simple, free-of-charge registration process. If you would like to sign up, please visit the Customer Access link at www.txtavsupport.com to register.